

CRITTER CHATTER MAGAZINE



NEWS FROM THE
SPCA OF WAKE COUNTY

ISSUE 4 | FALL 2025

Trusty (pictured here)
is alive today because
of donor support.

PAGE 7

**REAL
STORIES
OF LIVES
YOU SAVED**

PAGES 4-5

**OFFICIAL 2025
GIFT GUIDE**

PAGES 3-7

**BUILDING A
BETTER FUTURE**

PAGES 8-11

JOIN US
ONLINE AT

SPCAWAKE.ORG

CRITTER CHATTER MAGAZINE

Published quarterly by the SPCA of Wake County
©2025 SPCA of Wake County, Inc. All rights reserved.

Pet Adoption Center & Business Office
200 Petfinder Lane | Raleigh, NC | 27603
call: 919-772-2326 visit: spcawake.org
nonprofit tax ID # 56-0891732



ABOUT US: Founded in Raleigh in 1967, SPCA Wake is an independent, 501(c)(3) animal welfare organization. Funded by charitable support,

we provide vital community programs that pick up where local government agencies leave off. We work in 59 NC counties through collaborative partnerships that save pets and help people.

We are not affiliated with the ASPCA and we do not receive tax dollars or government funds. We are supported by caring donors like YOU.

SPCA Wake holds a 4-star rating (highest rating possible) from Charity Navigator – the nonprofit sector's premier trust indicator.



ADOPT: spcawake.org/adopt
Kim Flowers, Vice President of Operations | adopt@spcawake.org

DONATE: spcawake.org/donate
Mondy Lamb, Vice President of Development
mlamb@spcawake.org

VOLUNTEER: spcawake.org/volunteer
Pam Schmalenberger, Dir. of Volunteer Services
pschmalenberger@spcawake.org

PRESIDENT & CEO
Kim Janzen, kjanzen@spcawake.org

2025 BOARD OF DIRECTORS

Bill Busby, Chair	David Keesee
David Coats, Chair-Elect	Laura Leslie
Patrick Walsh, Treasurer	Alex Mihajlov
Jill Newbold, Secretary	Arlem Mora
Michelle D. Connell	Zach Mussler
Cynthia Bastos	Chan Namgong
Debbie Gordon	Missy Orr
Dana Guzzo	Jodi Reed, DVM
Monique Jenkins-Fuller	Maria Ross-Estrada, DVM
	Maryanne Volkringer

IN A WORLD WHERE YOU CAN GIVE ANYTHING, GIVE KINDNESS



Your support means everything to us. Thank you for your kindness and making so much good work possible.

From disaster assistance to emergency care to helping orphaned and senior pets with basics like food and shelter – it's your support that makes it all possible. **For more stories about your impact, please see pages 4-5 of this issue.**

As the season of giving approaches, we ask you to help support our programs with a meaningful gift that will truly make a difference. **It is only because of your support that we are able to be a safe haven for pets in our local community and across the state.**

As the 2025 year comes to an end, the most ambitious project in the SPCA of Wake County's fifty-eight year history is just getting started. The new Pet Admission & Resource Center is slated to open in March 2026. You are invited to be a part of the campaign with a customized naming opportunity. Please see pages 10-11 for a floor plan of the new Center. Additional naming opportunities are online at spcawake.org/build.

I know that there are many worthy causes asking for help this year, and we are truly grateful that you have chosen to invest in us. **Your support allows us to provide lifesaving services to our local community, and for that, we are deeply grateful.**

When thinking about ways to give to SPCA Wake, please remember we accept gifts of stock and mutual funds, QCD disbursements from your IRA, and gifts directed from DAFs (donor advised funds). **Please contact me for more information on any of the above.**

Mondy Lamb
Vice President of Development
mlamb@spcawake.org

2025 HOLIDAY PET SPONSORSHIP OPTIONS



GIVE A GIFT THAT WILL CHANGE A PET'S LIFE.



EACH SPONSORSHIP INCLUDES:

- An embossed Sponsorship Certificate
- A Donation Acknowledgment Card and envelope with space to personalize a message
- Program Description Insert

See page 6-7 to order.





YOUR GIFT MAKES ALL THE DIFFERENCE



Pictured left: Your gift helps pets like Delta, who was rescued from cruel conditions inside a Raleigh puppy mill.



When senior dog Doe was surrendered, someone's holiday gift gave her the chance to spend her golden years with a loving family.

The season of giving is here, and what better gift than one that provides hope, health, and happiness for pets in need? Last year, hundreds of sponsors like you stepped up to help the pets in our community. Your generosity wrapped senior pets in comfort, provided injured animals a second chance, and filled countless food bowls—all while touching hearts across our community.

Every gift made through our sponsorship program directly transforms the lives of animals in need, and right now, countless pets are still waiting for their chance.

This holiday season, you can once again be the reason tails wag and hearts heal. The following stories show the real magic your sponsorship gifts make possible:

1) SENIOR PET SPONSORSHIP - DOE

Few things are sadder than a devoted senior pet suddenly left without the family they've spent a lifetime with. But unfortunately, this was Doe's story. After spending 10 years with her family, Doe was surrendered to the shelter when the children grew up and moved out, leaving her without the love she truly deserved. Gentle, patient, and endlessly sweet, Doe waited for the right adopter,

with whom she could live out her golden years.

Because of you, we were able to give her that time. Your gift today to sponsor a Senior Pet makes it possible for us to give elderly animals like Doe as much time as they need to find their happily-ever-after.

2) INJURED PET SPONSORSHIP - AVALON

When Avalon first arrived at SPCA Wake, it became clear she needed more than just a safe place to stay. She had been born with deformed dewclaws that were attached only by skin, fragile and constantly at risk of severe tearing. Thankfully, a generous hero purchased an Injured Pet Sponsorship, so Avalon was able to receive the surgery she needed right away. Her dewclaws were removed safely, sparing her a future injury and allowing her to play like a typical puppy.

Your gift of an Injured Pet Sponsorship today means we can jump into action to provide surgery and special medical attention for pets in need.

3) OVERLOOKED PET SPONSORSHIP - JEBEDIAH

Some pets are adopted within days of arriving at

SPCA Wake, while others, like Jebediah, spend far longer waiting for someone to truly see them. When this raggedy tomcat first arrived, years of surviving on the streets had left him in rough shape, with painful mats, infections, and **even old BB pellets lodged beneath his fur**. But thanks to a generous donor like you, this long-overlooked cat received the love and care he deserved.

And then, one day, the right adopter walked in and saw him. Jebediah, now named Grump, spends his days getting cuddles, kisses, and even piggyback rides in a home that cherishes him completely. Your gift of an Overlooked Pet Sponsorship ensures the next pet like Jebediah won't be forgotten—they'll be given the time, care, and love they need until their perfect family finds them.

4) SPECIAL NEEDS PET SPONSORSHIP - CARMICHAEL

Every pet deserves the chance to feel safe and loved, no matter their challenges. Carmichael, a kitten who lost both eyes to severe infection, was on the euthanasia list at a rural shelter. When we were contacted for help, a sponsor just like you was the reason we were able to say a resounding “yes.”

In SPCA Wake foster care, Carmichael's caregivers adjusted their home so he could navigate their world with confidence while he waited for the family meant for him. And when it came time for adoption, he found the perfect match—a couple who have welcomed blind cats into their hearts for 25 years. Your gift to sponsor a Special Needs Pet will give the next pet like Carmichael the care they need to adapt and to find families who will cherish them exactly as they are.

5) HUNGRY PET SPONSORSHIP - TEDDY

It's unfortunately not uncommon for pets to arrive at our door hungry or malnourished. But even so, Teddy was a drastic case. You could see every bone in his body, and though he should've weighed about 55 pounds, he weighed only 32. He was too weak to maneuver stairs or stand up for more than a minute or two at a time. **He was mere days away from perishing due to starvation.**

But thanks to a hero like you who purchased a Hungry Pet Sponsorship, we were able to respond to the urgency of his condition. Teddy received medicine and fluids, a strict feeding schedule for encouraging weight gain, and the comfort of a foster home where he could finally rest. And over several months, Teddy came back to life. Now he's in a happy home and thriving at a healthy weight. Your gift today of a Hungry Pet Sponsorship provides nutritious food for the pets in our shelter and allows them to experience the peace of falling asleep with a full belly.



When Avalon needed surgery, someone's holiday gift made sure she got the medical care she needed.



Jebediah's family was out there – and someone's holiday gift gave him the extra time he needed to find them.



As a blind kitten, Carmichael needed extra care, and someone's holiday gift made sure he was never left behind.



When Teddy was rescued, emaciated and near death, someone's gift gave him the chance to heal and thrive.



WAYS TO PLACE YOUR ORDER:

- To order by mail, see page 7
- To order online, visit spcawake.org/giftguide
- To order by phone, call Kassie, SPCA Stewardship Coordinator at 919-532-7065

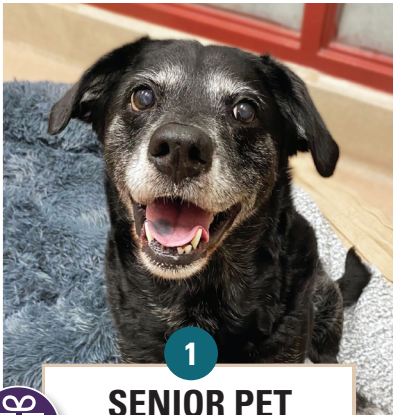

1



SENIOR PET SPONSORSHIP

- **\$25 Silver Level**
provides joint health supplements for a senior pet
- **\$100 Gold Level**
provides veterinary diagnostics for senior pets' specific needs
- **\$500 Platinum Level**
makes you a senior pet's Guardian Angel sponsor and provides a biopsy and cancer removal for one senior pet



2



INJURED PET SPONSORSHIP

- **\$25 Silver Level**
provides pain relief for a critically injured pet
- **\$100 Gold Level**
provides an injured pet with critical supplies like bandages, IV fluids, and medications
- **\$500 Platinum Level**
makes a full medical rescue possible for a pet with traumatic injuries, from emergency care to rehabilitation



3



OVERLOOKED PET SPONSORSHIP

- **\$25 Silver Level**
provides an overlooked pet with ongoing daily care like food, water, and medications
- **\$100 Gold Level**
supports efforts to spotlight overlooked pets for adoption
- **\$500 Platinum Level**
provides pets with toys, breaks in a foster home, and day trips out of the shelter



4



SPECIAL NEEDS PET SPONSORSHIP

- **\$25 Silver Level**
provides daily care and comfort for a pet living with special needs
- **\$100 Gold Level**
supports treatment or mobility aids for differently-abled pets
- **\$500 Platinum Level**
provides a custom wheelchair or mobility device for a pet with limb loss



5



HUNGRY PET SPONSORSHIP

- **\$25 Silver Level**
fills a hungry belly for a month with nourishing meals
- **\$100 Gold Level**
provides specialized nutrition to save a starving pet's life
- **\$500 Platinum Level**
supplies prescription food to help a pet with chronic illness find a loving home



6



SPCA WAKE'S GREATEST NEED

- Can't decide which package to sponsor? We can help by choosing for you! These gifts will be put towards the most urgent needs or the least funded of the programs listed.
- **\$25 Silver Level**
- **\$100 Gold Level**
- **\$500 Platinum Level**

ORDER FORM

SPONSORSHIP PACKAGES

QUANTITY

SILVER \$25	GOLD \$100	PLATINUM \$500
<input type="checkbox"/> Senior Pet Sponsorship		
<input type="checkbox"/> Injured Pet Sponsorship		
<input type="checkbox"/> Overlooked Pet Sponsorship		
<input type="checkbox"/> Hungry Pet Sponsorship		
<input type="checkbox"/> Special Needs Pet Sponsorship		
<input type="checkbox"/> Wherever is Needed Most		
TOTAL QUANTITY		
TOTAL DONATION AMOUNT		

WAYS TO ORDER

NEED HELP?

- support@spcawake.org
- 919-532-7065

► TO GIVE BY MAIL:

Select your Sponsorship / Gift Packages (above) and use the enclosed envelope to mail in your gift.

CHOOSE YOUR GIFT DELIVERY OPTIONS:

- ☐ Send packages to my address – or
- ☐ Send packages to another address. *Please include send-to names and addresses on a separate sheet of paper with your order.*

► ORDER ONLINE:

For easy ordering, visit our online holiday store at **SPCAWAKE.ORG/GIFTGUIDE** or scan the QR code with your phone camera.



CHOOSE YOUR GIFT DELIVERY OPTIONS:

- ☐ Select standard postal mail – or
- ☐ Pick up in person at SPCA Wake's Pet Adoption Center in Raleigh.

► BY PHONE:

Call Kassie, SPCA Stewardship Coordinator at 919-532-7065.

Donations made through this fundraising effort will fund the programs selected. If program budgets are met for the fiscal year ending 6-30-2026, your gift will be used to support the mission of SPCA Wake wherever needed most. Questions? Let us know!

Your gift is tax-deductible. SPCA Wake is a 501(c)(3) organization, Tax ID # 56-0891732.



Your lifesaving gift helps pets like Trusty find families to love.

THEIR TRUST IS IN YOU

Trusty (pictured above and on the cover) is a staff favorite at SPCA Wake.

His saggy skin, droopy ears, and gentle nature make him impossible not to love. But behind his sweet face is a sobering truth—**many dogs like Trusty never make it out of North Carolina shelters.**

Trusty came from a high-intake animal shelter where only 1 in 5 survives. **But because of your support, Trusty was rescued** and given the second chance he deserves.

When you purchase a lifesaving sponsorship, you say “yes” to pets like Trusty when all they've known is “no.”

You give a dog the chance to find a family, a kitten the chance to play, a rabbit the chance to hop. **You give them life**—a gift beyond measure. Thank you for the lifesaving you make possible.



MAKING ROOM
FOR MORE
LOVE

SPCA OF WAKE COUNTY
EST. 1967 | RALEIGH, NC



BUILDING A BETTER FUTURE

*Pictured:
Photo taken on 8-30-25,
showing the exterior of
the new Pet Admission &
Resource Center.*

TOGETHER WE CAN CHANGE THEIR WORLD. JOIN THE CAMPAIGN TODAY!

SPCA Wake works in over 50 counties across our state, supporting many rural and resource-strapped areas to save more pet lives and help more people.

The number of healthy pets euthanized in North Carolina's public animal shelters is a heartbreaking symptom of the real issue: a lack of necessary resources to keep pets in homes, with their families, and out of animal shelters.

The solution is North Carolina's first-ever Regional Campus for Pets & People. The new campus, and the programs and services we will be able to provide, will help transform communities and deliver profoundly needed resources for people and pets in our immediate community and beyond.

Progress is being made on the new Peggy Garner Britt Pet Admission & Resource Center. This state-

of-the-art facility is the cornerstone of the SPCA of Wake County's new Susan and Randall Ward Regional Campus for Pets and People. We've raised \$23 million in private support for the project, leaving a balance of \$4.5 million to close the gap and get us to opening day.

The new building is slated for a grand opening in March 2026, and **will touch over one million pets and hundreds of thousands of families during its lifetime.** This project provides a once-in-a-generation opportunity to make substantial, sustainable, and lasting improvements in the lives of pets, people, and our North Carolina community for decades to come.

Will you consider a named gift?

Please review the naming opportunities on page 10 and at spcawake.org/build. Donor Care Team: support@spcawake.org or 919-532-7065. Contact Mondy Lamb, VP of Development at: MLamb@spcawake.org or 919-532-2086.

Our Vision is a Humane Community. That begins with

THE END OF EUTHANASIA OF ADOPTABLE PETS

Change starts here – But not without you!



The new Pet Admission & Resource Center will help SPCA Wake achieve these four lifesaving initiatives to transform our community:



INITIATIVE #1:

DECREASE THE NUMBER OF PETS ENTERING SHELTERS

- Provide more prevention services by doubling the number of low- or no-cost spay/neuter surgeries to 10,000 annually
- Provide robust assistance programs to families in need that help pets stay in their homes and out of animal shelters
- Provide training classes and resources to address challenging pet behaviors such as destructive chewing or litterbox issues
- Expand collaborative partnerships with rural shelters
- Deepen our work in the greater Wake County area



INITIATIVE #2:

INCREASE THE NUMBER OF PETS LEAVING SHELTERS

- Transfer homeless pets from under-resourced shelters in rural counties to the Triangle area where pet adoption demand is high
- Increase available resources for sick and injured shelter animals
- Leverage public/private partnerships to work together toward a shared vision and collective impact
- Work collaboratively with high-intake public shelters to increase their capacity for care and spay/neuter efforts for pets being adopted into their communities



INITIATIVE #3:

CHANGE PEOPLE'S HEARTS & MINDS

- Create youth education programs that teach kids the importance of kindness and compassion
- Develop community-based programs through collaborative partnerships with human service organizations



INITIATIVE #4:

MAKE SURE WE HAVE THE RESOURCES TO DO THE FIRST THREE THINGS

- The physical space necessary for animal housing and people-focused programming
- Professional staff, especially in the areas of veterinary medicine, high-volume spay/neuter, and pet behavior
- The generous support of a passionate community



Get involved today spcawake.org/build



Make a gift today for enduring change.

GET INVOLVED



NAMING OPPORTUNITIES

Peggy Garner Britt Pet Admission & Resource Center

Help build a better future for the pets and people of North Carolina. Leave a lasting legacy to help transform our community. You can choose to feature your name and/or the name of a beloved pet or person on any of the following spaces. ***Gifts of \$50,000 or more may be pledged over 1 to 5 years.*** For a complete list of naming opportunities, visit spcawake.org/build.

LOCATION: VETERINARY MEDICAL CENTER

• Clinic Vestibule (Cat/Dog)	\$250,000
• Radiology / X-Ray Room (Cat/Dog)	\$250,000
• Cat Surgery Ward	\$250,000
• SPCA Feline Treatment	\$100,000
• Neonate Kitten Housing	\$100,000
• TNR / Feral Cats	\$100,000
• Feline Medical Isolation Room	\$50,000
• Pack/Prep Area (Cat/Dog)	\$50,000
• Laundry/Storage (Cat/Dog)	\$50,000
• Medical Director Office	\$50,000
• Induction Table #1 (Cat/Dog)	\$25,000
• Induction Table #2 (Cat/Dog)	\$25,000
• Clinic Restroom	\$25,000
• Heartworm Treatment Dog Kennel (8)	\$10,000
• Cat Treatment Kennel Bank (4)	\$10,000

LOCATION: RESOURCE CENTER

• Lobby – Exam Room #1	\$100,000
• Lobby – Exam Room #2	\$100,000
• Foster – Exam Room #3	\$50,000
• Garage – Exam Room #4	\$50,000
• Cat Holding Room	\$50,000
• Community Impact Team	\$50,000
• Intake Storage Room	\$50,000
• Foster Office	\$50,000
• Intake Manager Office	\$50,000
• Intake Specialist Team Office	\$50,000
• Small Meeting Room	\$50,000
• Flexible Cat/Small Pet Holding Room	\$25,000
• Transfer Garage Dog Kennels (6)	\$10,000
• Lobby Scale	\$10,000

LOCATION: LEARNING CENTER

• Learning Center Vestibule	\$250,000
• Storage Room #1	\$25,000
• Storage Room #2	\$25,000
• Single Restroom	\$25,000
• Women's Restrooms (cat tiles)	\$25,000
• Men's Restrooms (dog tiles)	\$25,000

LOCATION: DOG HOUSING

• Dog/Cat Loft 1 - Play Yard	\$50,000
• Dog Loft 5 - Play Yard	\$50,000
• Dog Loft 6 - Play Yard	\$50,000
• Dog Loft 7 - Play Yard	\$50,000
• Canine Medical Isolation 1	\$25,000
• Canine Medical Isolation 2	\$25,000
• Dog Housing Kennel (35)	\$10,000

LOCATION: CAT HOUSING

• Cat Loft 3 (Mom & Babies) / Flex Cat	\$100,000
• Feline Exam Room	\$50,000
• Feline Medical Isolation – 1	\$25,000
• Feline Medical Isolation – 2	\$25,000
• Feline / Rabbit Medical Isolation	\$25,000
• Catio 2	\$25,000
• Catio 4	\$25,000
• Cat Condos (8)	\$10,000
• Flex Cat Housing Kennel (3)	\$10,000

LOCATION: OTHER

• Transfer Garage	\$100,000
• Main Storage Room	\$100,000
• Staff Breakroom	\$50,000
• Food Prep	\$50,000
• Laundry	\$50,000
• Bathing Alcove	\$25,000

NEW PET ADMISSION & RESOURCE CENTER FLOOR PLAN

We would be delighted to help you dedicate a commemorative space in the new building, where thousands of animals will find compassion and refuge. Explore the new floor plan below and see what areas of the new building resonate with you! **Reserve your named gift** by filling out a Gift Form (found online at spcawake.org/build) and contacting Mondy Lamb at: MLamb@spcawake.org or 919-532-2086.

FELINE HOUSING

CANINE HOUSING

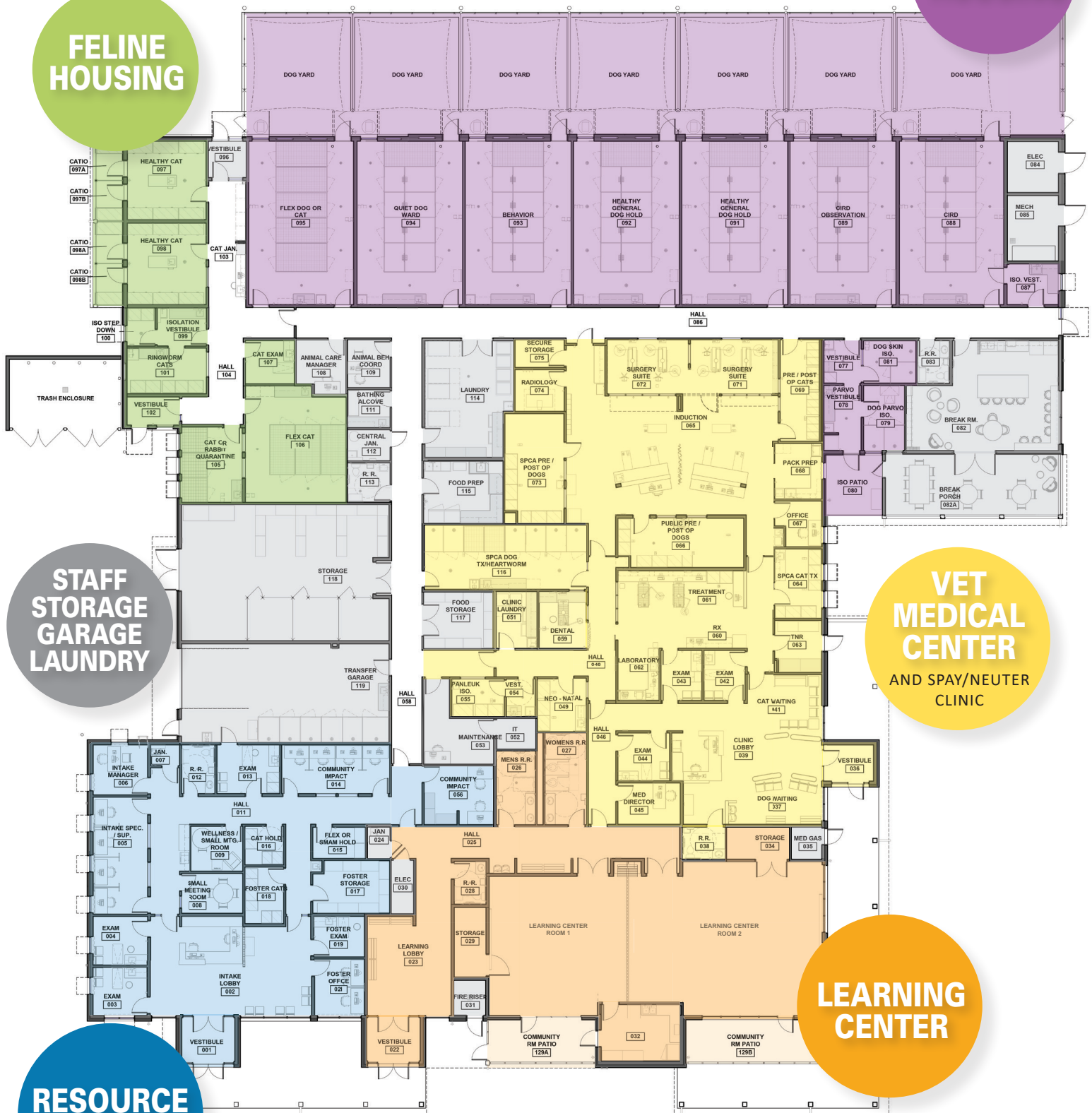

RESOURCE CENTER

LEARNING CENTER

**VET MEDICAL CENTER
AND SPAY/NEUTER CLINIC**

**STAFF STORAGE
GARAGE
LAUNDRY**

More Options: spcawake.org/build

JOIN US ONLINE AT SPCAWAKE.ORG | 11

JOIN THE MONTHLY GIVING CLUB

Enjoy your
choice of
thank you gift
to show your
support!

Scan here to
become a new
member:



TO SIGN UP:

Scan the QR code above, visit spcawake.org/monthlygiving, or call Gwyn, SPCA Donations Manager at 919-532-2082.

ALREADY A MONTHLY DONOR?

If we haven't already reached out, contact Gwyn at 919-532-2082 or glong@spcawake.org to redeem your thank you gift!

New and
existing
members
get an
exclusive
t-shirt or
tote!



*Every day, pets arrive
at our door needing urgent help.*

And when they do, we absolutely must have the resources already in place to be able to save them.

As a Monthly Donor, YOU help make rescues happen every month. This is a **special group of the SPCA's most passionate supporters** who make it possible to plan for rescue efforts today and in the future by signing up to make automatic monthly gifts.

Please join this lifesaving group of animal lovers like you!